



## Electrical Commercial and Industrial

[Products](#) | [Documentation & Literature](#) | [News & Tradeshows](#) | [Support](#)

[United States](#) > [Energy](#) > [Electrical Commercial and Industrial](#) > [Products](#) > [Electrical Commercial & Industrial Products Catalog](#) > [Lugs and Connectors](#) > [Lugs](#) > [One Hole Lugs](#) > 3M™ Scotchlok™ Copper One Hole Lug 30019, up to 35 kV, 4 AWG, Gray

[Find An Account Rep](#)

[Where To Buy \(Find A Distributor\)](#)

[Contact Us](#)

# 3M™ Scotchlok™ Copper One Hole Lug 30019, up to 35 kV, 4 AWG, Gray

3M ID 80610033245 UPC# 00054007124511 Part Number 30019

[Print](#)

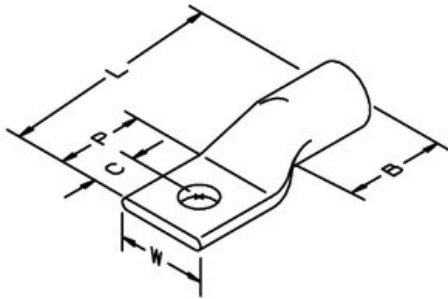

This lug has a 1/4 in Stud Size, a 0.247 in (6,3 mm) I.D., and a 1.940 in (49,3 mm) length.

**Need Help?**

**Questions?** We can help  
[Contact Us](#)



[Like](#) Be the first of your friends to like this.

**Overview**

**Documents**

The 3M™ Scotchlok™ Copper One Hole Lug 30019 is used on copper conductors only. It is constructed of one-piece, seamless, high-conductivity copper.

### Specifications

<b>Barrel Length</b>	0.75 Inch
<b>Barrel Length (metric)</b>	19.1 mm
<b>Barrel Style</b>	Standard Barrel
<b>Center of Hole to End of Pad</b>	0.37 Inch
<b>Center of Hole to End of Pad (metric)</b>	9.5 mm
<b>Color</b>	Gray
<b>Conductor Sizes</b>	4 AWG
<b>Connector Description</b>	One hole
<b>Connector Material</b>	Copper
<b>For Use With</b>	Copper Conductor Only
<b>Inside Diameter</b>	0.24 Inch
<b>Inside Diameter (metric)</b>	6.2 mm
<b>Length</b>	1.94 Inch
<b>Length (Metric)</b>	49.3 mm
<b>Lug Base Metal</b>	Copper

<b>Number of Holes</b>	1
<b>Outside Diameter</b>	0.34 Inch
<b>Outside Diameter (metric)</b>	8.6 mm
<b>Pad Length</b>	0.89 Inch
<b>Pad Length (metric)</b>	22.6 mm
<b>Pad Width</b>	0.48 Inch
<b>Pad Width (metric)</b>	12.3 mm
<b>RoHS 2011/65/EU Compliant</b>	Yes
<b>RoHS EU Comments</b>	RoHS 2011/65/EU compliant without exemption <a href="#">*Important RoHS information</a>
<b>Stud Sizes</b>	1/4 Inch
<b>Trademark</b>	Scotchlok